

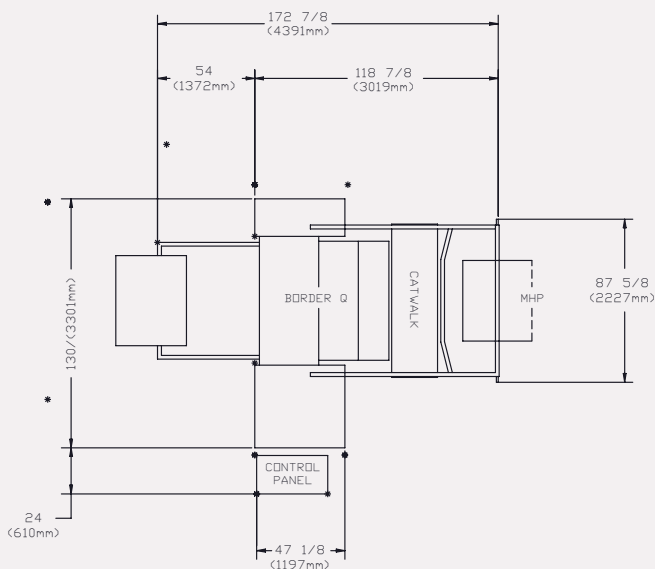

B45

Border Quilter

This compact border quilter from Gribetz International uses the same Gribetz technology you trust with mattress panels to create fashionable borders that don't sacrifice a profitable production rate.



SPECIFICATIONS	B45
Speed - Max-rpm	1000
Speed- Recommended T&J-rpm	850
Available widths	45"/114 cm
Number of needle bars	3
Needle bar spacing	3"/7.62 cm between bars
Needle spacing	1"/2.54 cm
Needle size	180/140
# of loopers	45
Looper bases	102
Stitch length	5-10 SPI
Recommended stitch length	7 SPI
Quilt Package	Up to 2"/5.08 cm
Pattern Compensation	Yes
Equistitch	Yes
Modem	Yes
Air Pressure	90 psi/6.2 bar
Air Consumption	1.2 CFM
Current (amps)	40, 60 or 70 depending on Voltage
Voltage	Any 3 Phase Voltage- Includes Multi-tap Transformer
CE Approved	Yes
Weight	10,120 lbs/4,590 kg

The B45 combines stylish creativity and mass production efficiency. Its innovative stitching and integrated slitters make it possible to produce high-speed intricate quilting, applied decorative ribbons, and tapes while maintaining high-yield throughput.

- Designed for a highly efficient border work cell.
- Can produce enough quilted border to accommodate the quilt panel production of two panel quilters.
- Capable of quilting most continuous pattern styles and Tack & Jump® patterns.
- Runs at speeds up to 1000 rpm.
- Includes integrated border slitter and wind-up device.
- Includes Gribetz Point & Sew™ computerized touchscreen controls.

Optional integrated decorative ribbon application systems available.

Global Systems Group® (GSG) is a collection of the world's leading mattress machinery companies. These GSG machinery companies represent leading-edge technology in computerized quilting machines and panel cutters, automated and conventional sewing machines, material handling solutions, and mattress-packaging equipment.

800-343-8138 • 417-237-6254 • GSGcompanies.com

GLOBAL SYSTEMS GROUP
 A DIVISION OF LEGGETT & PLATT
 131 Zapletal Way
 Carthage, MO 64836 USA